

PENTA-TILLER



- Optimal clearance.
- Depth control via depth wheels - 0-15 cm working depth.
- 57 cm frame height / 50 cm bar spacing / 70 cm tine spacing / 14 cm row spacing.
- 70x12 mm tines.
- Supplied with either 180 mm goose foot points or 52 mm reversible wear points.
- Three-point linkage with cat. 3 pins and cat. 2 distance.

MACHINES

Work Width, m	Point Type	No. of Tines	Power Req., HP	Lifting Req., kg	Transport Width, m	Weight, kg	Item Number
1-SECTION, RIGID MODELS							
3.00	Goose foot point, 180 mm	21	70 - 120	2,450	3.00	1,360	4600031
3.00	Reversible wear point, 52 mm	21	70 - 120	2,450	3.00	1,360	4600030
3.50	Goose foot point, 180 mm	25	80 - 150	2,650	3.50	1,470	4600036
3.50	Reversible wear point, 52 mm	25	80 - 150	2,650	3.50	1,470	4600035
4.00	Goose foot point, 180 mm	27	90 - 180	2,850	4.00	1,580	4600041
4.00	Reversible wear point, 52 mm	27	90 - 180	2,850	4.00	1,580	4600040
2-SECTION, HYDRAULIC MODELS							
4.00	Goose foot point, 180 mm	^{1*} 26	90 - 180	4,020	2.48	2,230	4600043
4.00	Reversible wear point, 52 mm	^{1*} 26	90 - 180	4,020	2.48	2,230	4600042
5.00	Goose foot point, 180 mm	^{1*} 32	110 - 220	4,220	2.48	2,340	4600051
5.00	Reversible wear point, 52 mm	^{1*} 32	110 - 220	4,220	2.48	2,340	4600050
6.00	Goose foot point, 180 mm	^{1*} 40	130 - 240	4,410	2.48	2,450	4600061
6.00	Reversible wear point, 52 mm	^{1*} 40	130 - 240	4,410	2.48	2,450	4600060
7.00	Goose foot point, 180 mm	^{1*} 46	150 - 260	4,550	2.48	2,560	4600071
7.00	Reversible wear point, 52 mm	^{1*} 46	150 - 260	4,550	2.48	2,560	4600070

^{1*}Requires 1 double-acting oil outlet.

STANDARD EQUIPMENT

- 180 mm. goose foot points or 52 mm. reversible wear point.
- Automatic transport locks – hydraulically operated with folding function (only foldable models).
- Wheels:
 - 3.00 - 4.00 m, rigid 1-section: 2 pcs. 200/60 x 14.5 – 10 PLY.
 - 4.00 - 7.00 m, 2-section w/hydr. folding: 4 pcs. 200/60 x 14.5 – 10 PLY.

EXTRA EQUIPMENT

Work Width, m	Description	Weight, kg	Item Number
3.00 - 4.00	LED lights with wire and socket, mounted on rigid models	3	4519510
4.00 - 7.00	LED lights with wire and socket, mounted on 2-section-models	3	4519515
3.00 - 7.00	Extra set of points - goose foot point 180 mm (Additional price per meter)	-	4600200
3.00 - 7.00	Extra set of points - reversible wear point 52 mm (Additional price per meter)	-	4600201
3.00 - 7.00	Auxiliary spring for 70x12 mm tine (Additional price per meter)	-	4600210

EXTRA EQUIPMENT (CONTINUED)

Work Width, m	Type	Description	Item Number
3.00	Rigid	Longfinger afterharrow	4600130
3.00	Rigid	Longfinger afterharrow with double tine row, individual depth adjustment	4600140
3.00	Rigid	Flat bar roller Ø410 mm	4600100
3.00	Rigid	Tube Roller Ø550 mm	4600105
3.00	Rigid	Longfinger afterharrow, single tine row after roller	3401904
3.00	Rigid	Top-Cutter with single knife roller for mounting between tractor and harrow.	4600110
3.00	Rigid	Spring-Board with spring tines for mounting between tractor and harrow.	4600120
3.50	Rigid	Longfinger afterharrow	4600131
3.50	Rigid	Longfinger afterharrow with double tine row, individual depth adjustment	4600141
3.50	Rigid	Flat bar roller Ø410 mm	4600099
3.50	Rigid	Tube Roller Ø550 mm	4600102
3.50	Rigid	Longfinger afterharrow, single tine row after roller	3401906
3.50	Rigid	Top-Cutter with single knife roller for mounting between tractor and harrow.	4600111
3.50	Rigid	Spring-Board with spring tines for mounting between tractor and harrow.	4600121
4.00	Rigid	Longfinger afterharrow	4600132
4.00	Rigid	Longfinger afterharrow with double tine row, individual depth adjustment	4600142
4.00	Rigid	Flat bar roller Ø410 mm	4600098
4.00	Rigid	Tube Roller Ø550 mm	4600103
4.00	Rigid	Longfinger afterharrow, single tine row after roller	3401908
4.00	Rigid	Top-Cutter with single knife roller for mounting between tractor and harrow.	4600112
4.00	Rigid	Spring-Board with spring tines for mounting between tractor and harrow.	4600122
4.00	Foldable	Longfinger afterharrow	4600133
4.00	Foldable	Longfinger afterharrow with double tine row, individual depth adjustment	4600143
4.00	Foldable	Flat bar roller Ø410 mm	4600101
4.00	Foldable	Tube Roller Ø550 mm	4600106
4.00	Foldable	Longfinger afterharrow, single tine row after roller	3401910
4.00	Foldable	Top-Cutter with single knife roller for mounting between tractor and harrow.	4600113
4.00	Foldable	Spring-Board with spring tines for mounting between tractor and harrow.	4600123
5.00	Foldable	Longfinger afterharrow	4600134
5.00	Foldable	Longfinger afterharrow with double tine row, individual depth adjustment	4600144
5.00	Foldable	Flat bar roller Ø410 mm	4600097
5.00	Foldable	Tube Roller Ø550 mm	4600104
5.00	Foldable	Longfinger afterharrow, single tine row after roller	3401912
5.00	Foldable	Top-Cutter with single knife roller for mounting between tractor and harrow.	4600114
5.00	Foldable	Spring-Board with spring tines for mounting between tractor and harrow.	4600124
6.00	Foldable	Longfinger afterharrow	4600135
6.00	Foldable	Longfinger afterharrow with double tine row, individual depth adjustment	4600145
6.00	Foldable	Flat bar roller Ø410 mm	4600096
6.00	Foldable	Tube Roller Ø550 mm	4600107
6.00	Foldable	Longfinger afterharrow, single tine row after roller	3401914
6.00	Foldable	Top-Cutter with single knife roller for mounting between tractor and harrow.	4600115
6.00	Foldable	Spring-Board with spring tines for mounting between tractor and harrow.	4600125
7.00	Foldable	Longfinger afterharrow	4600136
7.00	Foldable	Longfinger afterharrow with double tine row, individual depth adjustment	4600146
7.00	Foldable	Flat bar roller Ø410 mm	4600095
7.00	Foldable	Tube Roller Ø550 mm	4600108
7.00	Foldable	Longfinger afterharrow, single tine row after roller	3401916
7.00	Foldable	Top-Cutter with single knife roller for mounting between tractor and harrow.	4600116
7.00	Foldable	Spring-Board with spring tines for mounting between tractor and harrow.	4600126



Individual depth adjustment.

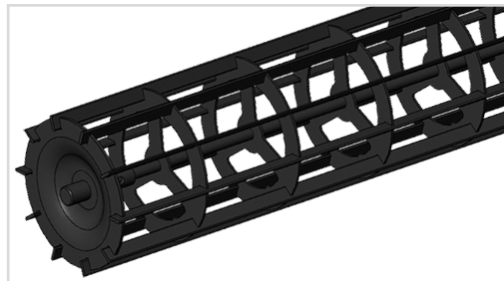

Flat bar roller Ø410 mm.

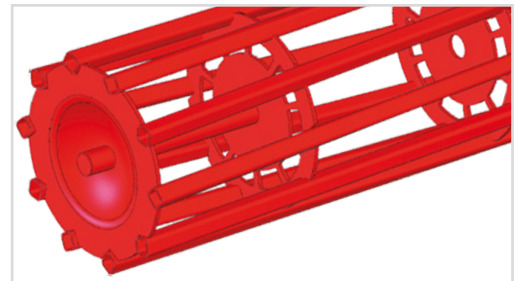

Tube Roller Ø550 mm.

MOUNTING SET FOR MULTI-SEEDER INCL. MOUNTING ON NEW PENTA-TILLER - MAX. 300 KG LOAD IN FINE SEED HOPPER.

Work Width, m	Type	Description	Item Number - 8 Outlets
3.00 - 4.00	Rigid	Mounting set for Multi-Seeder	4509930
4.00 - 7.00	Foldable	Mounting set for Multi-Seeder	4509940