

Extra Equipment

Points

While the standard 200 mm point covers most applications, a narrower 120 mm version and a wider 350 mm version are also available. By simply changing the point size, the Combi-Flex can be adapted for different soil types and working depths.

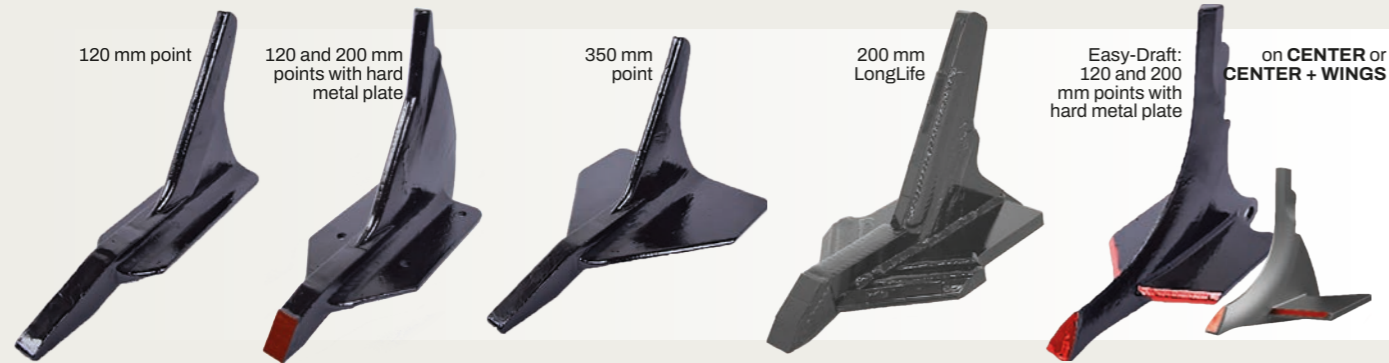

LED Lighting

LED lighting is available for all Combi-Tiller models.

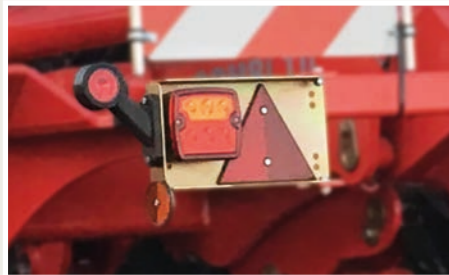

Warning Boards

Optional mounting on light brackets.



Easy-Draft

A 120 or 200 mm point with a lower working angle on the wings, where the front of the point is shortened and fitted with a tungsten carbide plate. This allows drainage to be carried out without disturbing the entire soil profile.



Technical Specifications



3.00 - 6.00 m



2,200 - 4,000 kg



150 - 300 hp



6 - 12 pcs.

Working Width, m	Model	Stone Protection	Number of Tines	Tine Spacing, cm	Power Requirement, hp	Weight, kg
3.00	Rigid	Shear Bolt	6	50	150	2,200
3.00	Rigid	Hydr. Auto Release	6	50	150	2,200
4.00	Rigid	Shear Bolt	8	50	200	2,500
4.00	Rigid	Hydr. Auto Release	8	50	200	2,500
4.00	Foldable	Shear Bolt	8	50	200	2,500
4.00	Foldable	Hydr. Auto Release	8	50	200	2,500
5.00	Foldable	Shear Bolt	10	50	250	3,250
5.00	Foldable	Hydr. Auto Release	10	50	250	3,250
6.00	Foldable	Shear Bolt	12	50	300	4,000
6.00	Foldable	Hydr. Auto Release	12	50	300	4,000



Combi-Flex

Flexibility with Minimal Disturbance



Tel.: +45 97 72 42 88
E-mail: info@he-va.com

Web: www.he-va.com

N.A. Christensensevej 34
DK-7900 Nykøbing Mors

Your HE-VA dealer



HE-VA reserves the right to make design and construction changes without notice



Combi-Flex – Flexibility at its Best!

The HE-VA Combi-Flex is a subsoiler designed to work on its own or in combination with a following implement.

By combining it with other implements, the number of passes can be reduced, which lowers time and fuel consumption, ultimately saving money!

The HE-VA Combi-Flex is also designed to operate independently of any subsequent implement.

This means the Combi-Flex can be lifted without changing the drawbar height, ensuring the working performance of the following implement is not affected.

That is flexibility at its best!

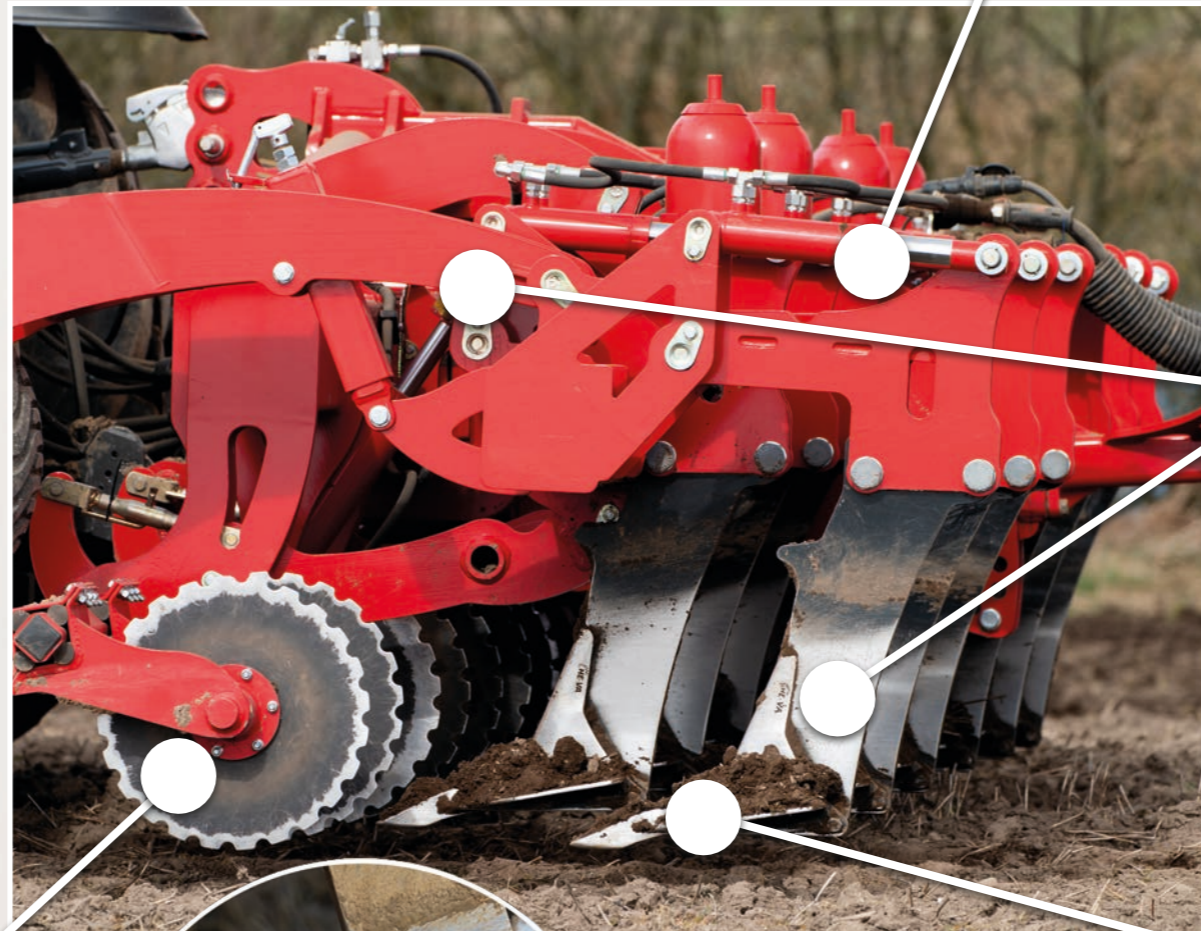
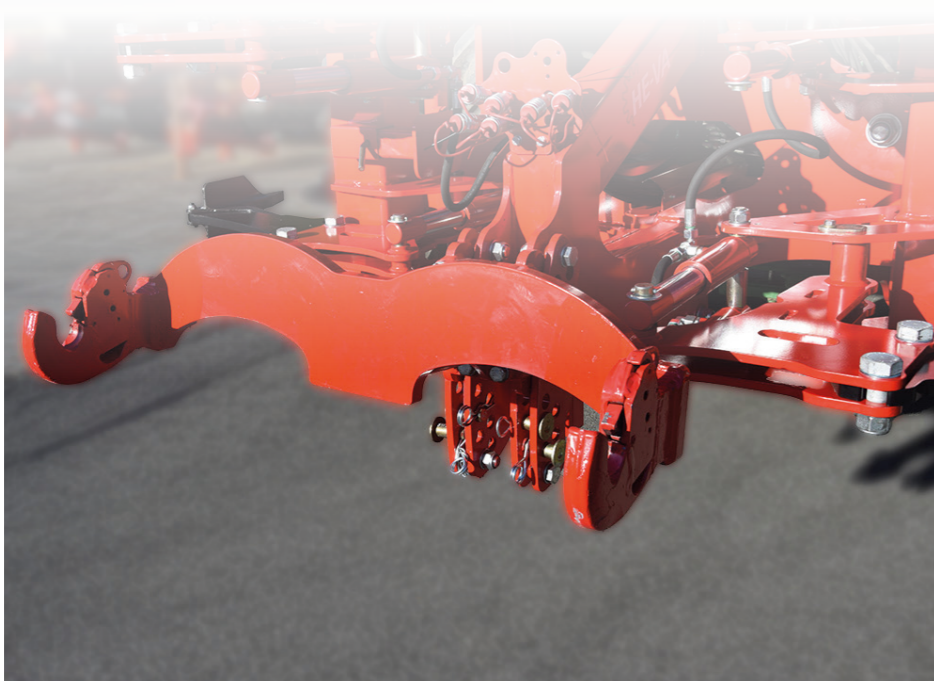

Stone Protection

Shear Bolt

The Combi-Flex is protected against overload via shear bolts mounted on each individual tine.

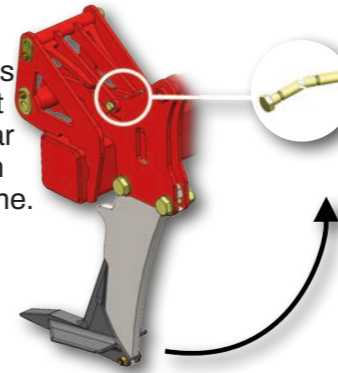

Hydr. Stone Protection

With hydraulic stone protection, the tine automatically returns to its working position after being released when hitting a stone.

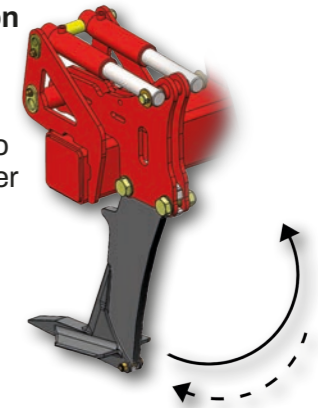

Working Depth

The Combi-Flex has a maximum working depth of 400 mm.

The working depth is hydraulically adjustable, and with the supplied spacers the maximum depth can be reduced.



This ensures a stable and even cultivation.

470 mm Serrated Coulters

A row of 470 mm coulters is located at the front of the Combi-Flex

The coulters cut through stubble and straw residues, vegetation and top soil.

The coulters ensure that the soil breaks up minimally during sub soiling, which also ensures that grass germination is minimised considerably.



Easy-Draft

For even lower disturbance, the Combi-Flex can be supplied as an option with 15 mm legs and Easy-Draft points! (Max. 300 mm working depth)



Standard Points

A standard Combi-Flex point is 200 mm wide and mounted on a 25 mm wide tine.

The point itself is made of cast steel, which is hardened to resist wear without becoming brittle.

A single bolt, located behind the support leg's heel, holds the point in place and allows for quick replacement.

