

PENTA-TILLER



- Optimal clearance
- Depth control via depth wheels - 0-15 sm. working depth
- 57 cm. frame height / 50 cm. bar spacing / 70 cm. tine spacing / 14 cm. row spacing
- 70x12 mm tines
- Supplied with either 180 mm goose foot points or 52 mm reversible wear points.

MACHINES

Work Width, m	Point Type	No. of Tines	Power Req., HP	Lifting Req., kg	Transport Width, m	Weight, kg	Item Number
1-SECTION, RIGID MODELS							
3.00	Goose foot point, 180 mm	21	70 - 120	2,450	3.00	1,360	4600031
3.00	Reversible wear point, 52 mm	21	70 - 120	2,450	3.00	1,360	4600030
3.50	Goose foot point, 180 mm	25	80 - 150	2,650	3.50	1,470	4600036
3.50	Reversible wear point, 52 mm	25	80 - 150	2,650	3.50	1,470	4600035
4.00	Goose foot point, 180 mm	29	90 - 180	2,850	4.00	1,580	4600041
4.00	Reversible wear point, 52 mm	29	90 - 180	2,850	4.00	1,580	4600040
2-SECTION, HYDRAULIC MODELS							
4.00	Goose foot point, 180 mm	^{1*} 29	90 - 180	4,020	2.48	2,230	4600043
4.00	Reversible wear point, 52 mm	^{1*} 29	90 - 180	4,020	2.48	2,230	4600042
5.00	Goose foot point, 180 mm	^{1*} 36	110 - 220	4,220	2.48	2,340	4600051
5.00	Reversible wear point, 52 mm	^{1*} 36	110 - 220	4,220	2.48	2,340	4600050
6.00	Goose foot point, 180 mm	^{1*} 43	130 - 240	4,410	2.48	2,450	4600061
6.00	Reversible wear point, 52 mm	^{1*} 43	130 - 240	4,410	2.48	2,450	4600060
7.00	Goose foot point, 180 mm	^{1*} 50	150 - 260	4,550	2.48	2,560	4600071
7.00	Reversible wear point, 52 mm	^{1*} 50	150 - 260	4,550	2.48	2,560	4600070

^{1*}Requires 1 double-acting oil outlet.

STANDARD EQUIPMENT

- 180 mm. goose foot points or 52 mm. reversible wear point
- Automatic transport locks – hydraulically operated with folding function (only foldable models)
- Wheels:
 - 3.00 - 4.00 m, rigid 1-section: 2 pcs. 200/60 x 14.5 – 10 PLY
 - 4.00 - 7.00 m, 2-section w/hydr. folding: 4 pcs. 200/60 x 14.5 – 10 PLY

EXTRA EQUIPMENT

Work Width, m	Description	Weight, kg	Item Number
3.00 - 4.00	LED lights with wire and socket, mounted on rigid models	3	4519510
4.00 - 7.00	LED lights with wire and socket, mounted on 2-section-models	3	4519515
3.00 - 7.00	Extra set of points - goose foot point 180 mm (Additional price per meter)	-	4600200
3.00 - 7.00	Extra set of points - reversible wear point 52 mm (Additional price per meter)	-	4600201

Work Width, m	Type	Description	Item Number
3.00	Rigid	Longfinger afterharrow	4600130
3.00	Rigid	Longfinger afterharrow with double tine row, individual depth adjustment	4600140
3.00	Rigid	Flat bar roller Ø410 mm	4600100
3.00	Rigid	Square tube roller Ø550 mm	4600105
3.00	Rigid	Longfinger afterharrow, single tine row after roller	3401904
3.00	Rigid	Top-Cutter with single knife roller for mounting between tractor and harrow.	4600110
3.00	Rigid	Spring-Board with spring tines for mounting between tractor and harrow.	4600120
3.50	Rigid	Longfinger afterharrow	4600131
3.50	Rigid	Longfinger afterharrow with double tine row, individual depth adjustment	4600141
3.50	Rigid	Flat bar roller Ø410 mm	4600099
3.50	Rigid	Square tube roller Ø550 mm	4600102
3.50	Rigid	Longfinger afterharrow, single tine row after roller	3401906
3.50	Rigid	Top-Cutter with single knife roller for mounting between tractor and harrow.	4600111
3.50	Rigid	Spring-Board with spring tines for mounting between tractor and harrow.	4600121
4.00	Rigid	Longfinger afterharrow	4600132
4.00	Rigid	Longfinger afterharrow with double tine row, individual depth adjustment	4600142
4.00	Rigid	Flat bar roller Ø410 mm	4600098
4.00	Rigid	Square tube roller Ø550 mm	4600103
4.00	Rigid	Longfinger afterharrow, single tine row after roller	3401908
4.00	Rigid	Top-Cutter with single knife roller for mounting between tractor and harrow.	4600112
4.00	Rigid	Spring-Board with spring tines for mounting between tractor and harrow.	4600122
4.00	Hydraulic	Longfinger afterharrow	4600133
4.00	Hydraulic	Longfinger afterharrow with double tine row, individual depth adjustment	4600143
4.00	Hydraulic	Flat bar roller Ø410 mm	4600101
4.00	Hydraulic	Square tube roller Ø550 mm	4600106
4.00	Hydraulic	Longfinger afterharrow, single tine row after roller	3401910
4.00	Hydraulic	Top-Cutter with single knife roller for mounting between tractor and harrow.	4600113
4.00	Hydraulic	Spring-Board with spring tines for mounting between tractor and harrow.	4600123
5.00	Hydraulic	Longfinger afterharrow	4600134
5.00	Hydraulic	Longfinger afterharrow with double tine row, individual depth adjustment	4600144
5.00	Hydraulic	Flat bar roller Ø410 mm	4600097
5.00	Hydraulic	Square tube roller Ø550 mm	4600104
5.00	Hydraulic	Longfinger afterharrow, single tine row after roller	3401912
5.00	Hydraulic	Top-Cutter with single knife roller for mounting between tractor and harrow.	4600114
5.00	Hydraulic	Spring-Board with spring tines for mounting between tractor and harrow.	4600124
6.00	Hydraulic	Longfinger afterharrow	4600135
6.00	Hydraulic	Longfinger afterharrow with double tine row, individual depth adjustment	4600145
6.00	Hydraulic	Flat bar roller Ø410 mm	4600096
6.00	Hydraulic	Square tube roller Ø550 mm	4600107
6.00	Hydraulic	Longfinger afterharrow, single tine row after roller	3401914
6.00	Hydraulic	Top-Cutter with single knife roller for mounting between tractor and harrow.	4600115
6.00	Hydraulic	Spring-Board with spring tines for mounting between tractor and harrow.	4600125
7.00	Hydraulic	Longfinger afterharrow	4600136
7.00	Hydraulic	Longfinger afterharrow with double tine row, individual depth adjustment	4600146
7.00	Hydraulic	Flat bar roller Ø410 mm	4600095
7.00	Hydraulic	Square tube roller Ø550 mm	4600108
7.00	Hydraulic	Longfinger afterharrow, single tine row after roller	3401916
7.00	Hydraulic	Top-Cutter with single knife roller for mounting between tractor and harrow.	4600116
7.00	Hydraulic	Spring-Board with spring tines for mounting between tractor and harrow.	4600126



Individual depth adjustment

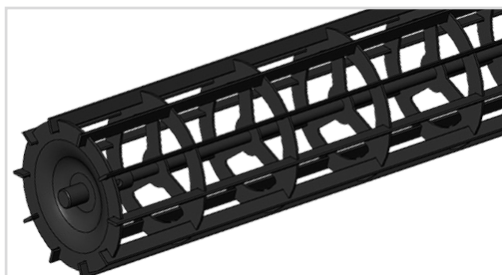

Flat bar roller Ø410 mm

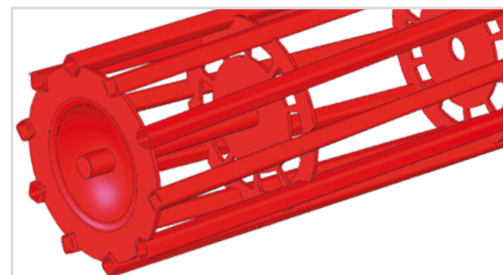

Square tube roller Ø550 mm

MOUNTING SET FOR MULTI-SEEDER INCL. MOUNTING ON NEW PENTA-TILLER - MAX. 300 KG LOAD IN FINE SEED HOPPER.

Work Width, m	Type	Description	Item Number - 8 Outlets
3.00 - 4.00	Rigid	Mounting set for Multi-Seeder	4509930
4.00 - 7.00	Hydraulic	Mounting set for Multi-Seeder	4509940